

永磁直行星齿轮电机 (内齿圈材质: 金属)

PM DC Planetary Gear Motor (Ring Gear Material: Metal)

**42JX150K/42ZY66** Φ42 加强型减速器, 允许转矩范围: 2N.m~15N.m  
42mm OD Reinforced Gearbox, Permissible Load Range: 2N.m~15N.m

● 外形和安装尺寸 Dimensions

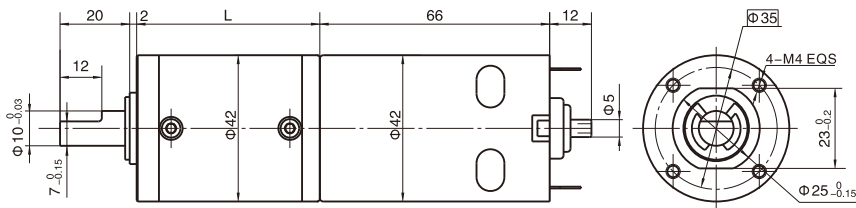

● 电动机主要技术参数 Motor Technical Data

电机型号 TYPE	额定电压 Rated voltage VDC	空载转速 No-load speed r/min	空载电流 No-load current A	额定转速 Rated speed r/min	额定转矩 Rated torque mN.m	输出功率 Output power W	额定电流 Rated current A	堵转力矩 Stall torque mN.m	堵转电流 Stall current A
42ZY66-1257	12	5700	0.8	4800	45	25	3.0	280	15.2
42ZY66-1277	12	7700	1.3	6500	65	35	5.0	240	20.5

● 齿轮减速电机主要技术参数 Gear Motor Technical Data

配置42ZY66-1257直流电机 (42ZY66-1257 DC Motor)

减速比 Reduction ratio	3.5	14	17	21	49	61	84	104	126	172	212	294	504
减速级数 Number of gear trains	1	2	2	2	3	3	3	3	3	4	4	4	4
减速器长度(L) Length(L) mm	32.5	39.2	39.2	39.2	46	46	46	46	46	52.5	52.5	52.5	52.5
空载转速 No-load speed r/min	1628	407	335	271	116	93	68	55	45	33	27	19	11
额定转速 Rated speed r/min	1371	343	285	229	98	79	57	47	38	28	23	16	9.5
额定转矩 Rated torque N.m	0.14	0.51	0.61	0.76	1.6	2.0	2.8	3.4	4.1	5.1	6.3	8.7	15
最大瞬间允许负载 Max. permissible load in a short time N.m	3	12	12	12	25	25	25	25	25	30	30	30	30

配置42ZY66-1277直流电机 (42ZY66-1277 DC Motor)

减速比 Reduction ratio	3.5	14	17	21	49	61	84	104	126	172	212	294
减速级数 Number of gear trains	1	2	2	2	3	3	3	3	3	4	4	4
减速器长度(L) Length(L) mm	32.5	39.2	39.2	39.2	46	39.2	46	46	46	52.5	52.5	52.5
空载转速 No-load speed r/min	2200	550	453	367	157	126	92	74	61	45	36	26
额定转速 Rated speed r/min	1857	464	382	310	133	106	77	62	51	38	30	22
额定转矩 Rated torque N.m	0.21	0.74	0.89	1.1	2.3	2.8	4.0	4.9	6.0	8.2	9.0	14
最大瞬间允许负载 Max. permissible load in a short time N.m	3	12	12	12	25	25	25	25	25	30	30	30

● 电动机特性图 Motor Characteristic Figure

