

无刷直流行星齿轮减速电机(内齿圈材质: 金属)

BLDC Planetary Gear Motor (Ring Gear Material: Metal)

28JXB30K/28ZWN77

Φ28 行星减速器, 允许转矩范围: 0.3N.m~3.0N.m
28mm OD Planetary Gearbox,
Permissible Load Range: 0.3N.m~3.0N.m



● 外形和安装尺寸 Dimensions

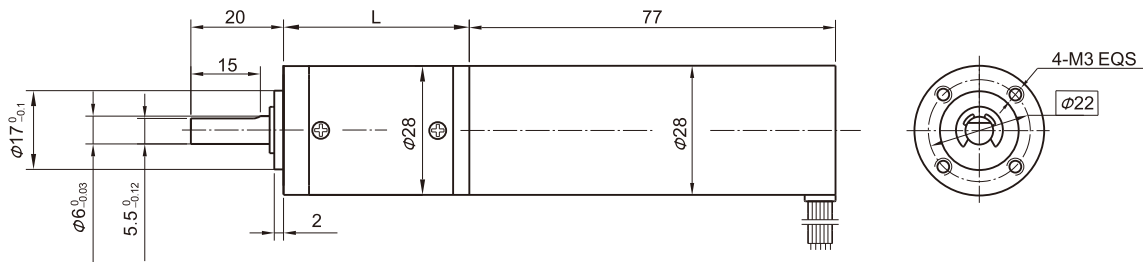

● 无刷电动机主要技术参数 Brushless Motor Technical Data

电机型号 TYPE	极数 Number of poles	相数 Number of phase	额定电压 Rated voltage VDC	空载转速 No-load speed r/min	额定转速 Rated speed r/min	额定转矩 Rated torque mN.m	额定功率 Rated power W	峰值扭矩 Peak torque mN.m	峰值电流 Peak current A	电阻 Line to line resistance ohms	电感 Line to line inductance mH
28ZWN77-2460	4	3	24	6000	3700	50	16	150	3	4.2	2.2

● 无刷行星齿轮减速电机主要技术参数 Brushless Gear Motor Technical Data

配置28ZWN77-2460无刷直流电机 (28ZWN77-2460 BLDC Motor)

减速比 Reduction ratio	3.7	5.2	14	19	27	51	71	100	139
减速级数 Number of gear trains	1	1	2	2	2	3	3	3	3
减速器长度(L) Length(L) mm	31.0	31.0	40.1	40.1	40.1	49.0	49.0	49.0	49.0
空载转速 No-load speed r/min	1617	1158	429	316	222	118	85	60	43
额定转速 Rated speed r/min	997	714	264	195	137	73	52	37	29
额定转矩 Rated torque N.m	0.17	0.23	0.57	0.77	1.1	1.9	2.5	2.5	2.5
最大瞬间允许负载 Max. permissible load in a short time N.m	1.0	1.0	3.5	3.5	3.5	7.5	7.5	7.5	7.5

● 接线方式 Wire Diagram

U	V	W	Vcc	Ha	Hb	Hc	GND
绿 Green	红 Red	黑 Black	黄 Yellow	蓝 Blue	橙 Orange	棕 Brown	白 White

26AWG UL1007